



intAct GEL-Power

Sealed GEL battery with grid plates | electrolyte gel-bonded | filled and charged | absolutely maintenance-free

Art.No.

GEL-75

Usage

intAct GEL-Power

Volt	12V
Capacity	63 AH (c5), 70 AH (c20), 80 AH (c100)
CCR -18°C (EN)	-
Electrolyte	diluted sulphuric acid
Electrolyte density	1,28 +/- 0,01 Kg/l (25° C)
Size (LxWxH)	260 x 171 x 210 mm
Weight	23,5 kg
Pos. of Terminal	1
Terminal	F-M6
Base plate	-

Size

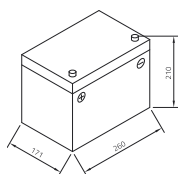

Pos. of Terminal 1

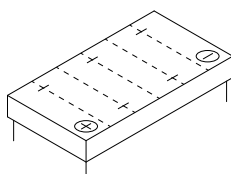

Terminal F-M6

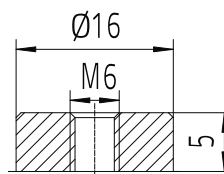

Base plate -

As of 26.08.2024